

PARKVIEW

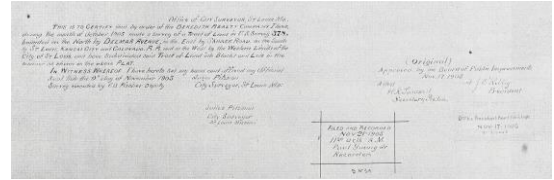

Office of CITY SURVEYOR, St Louis MO.

THIS IS TO CERTIFY that by order of the BEREDITH REALTY COMPANY I have, during the month of October 1905 made a survey of a Tract of Land in U.S. Survey 378, bounded on the North by DELMAR AVENUE, on the East by SKINKER ROAD, on the South by ST LOUIS, KANSAS CITY and COLORADO R.R. and on the West by the Western Limits of the City of St. Louis, and have subdivided said Tract of Land into Blocks and Lots in the manner as shown on the above PLAT.

IN WITNESS WHEREOF I have hereto set my hand and affixed my Official Seal this the 9th day of November 1905
Julius Pitzman
Survey executed by C.O. Fischer, Deputy City Surveyor, St. Louis, MO

Julius Pitzman
City Surveyor
St. Louis, Missouri

(Original)
Approved by the Board of Public Improvements Nov 19, 1905
Attest

S J O'Reilly
H. R. Farewell, President
Secretary Pro. Tem.

Office President Board Public Impts

Nov 17 1905

ST LOUIS
FILED AND RECORDED
Nov-21-1905
11:20 o'clk a.m.
Paul Young, Jr
Recorder
D. No. 29

(ST. LOUIS CITY PLAT BOOK 17 PAGE 42, Text Transcript)

DESIGNED, SUBDIVIDED AND IMPROVED BY PITZMAN'S CO. OF SURVEYORS AND ENGINEERS

615 Chestnut Str, St Louis, MO

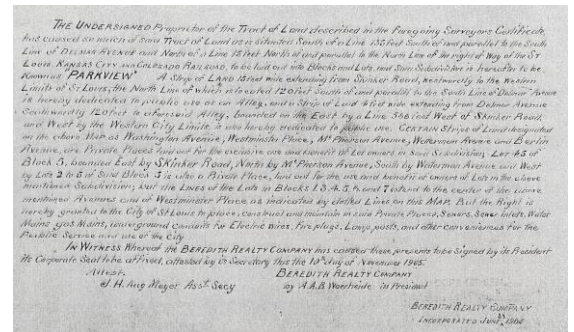

THE UNDERSIGNED Proprietor of the Tract of Land described in the Foregoing surveyors Certificate, has caused so much of said Tract of Land as is situated South of a Line 135 feet South of and parallel to the South Line of DELMAR AVENUE and North of a Line 15 feet North of and parallel to the North Line of the right of Way of the St Louis, Kansas City and Colorado Railroad, to be laid out into Blocks and Lots, and Said Subdivision is hereafter to be known as "PARKVIEW".

A Strip of LAND 15 feet wide extending from Skinker Road, westwardly to the Western Limits of St. Louis, the North Line of which is located 120 feet South of and parallel to the South Line of Delmar Avenue is hereby dedicated to public use as an Alley, and a Strip of Land 4 feet wide extending from Delmar Avenue Southwardly 120 feet to aforesaid Alley bounded on the East by a Line 566 feet West of Skinker Road, and West by the Western City Limits is also hereby dedicated to public use.

CERTAIN Strips of Land designated on the above MAP as Washington Avenue, Westminster Place, McPherson Avenue, Waterman Avenue, and Berlin Avenue, are Private Places laid out for the exclusive use and benefit of Lot owners in Said Subdivision; Lot 45 of Block 5, bounded East by Skinker Road, North by McPherson Avenue, South by Waterman Avenue and West by Lots 2 to 5 of Said Block 5 is also a Private Place, laid out for the use and benefit of owners of Lots in the above mentioned Subdivision; but the LINES of the Lots in Blocks 1, 3, 4, 5, 6, and 7 extend to the center of the above mentioned Avenues and of Westminster Place, as indicated by dotted Lines on this MAP.

But the Right is hereby granted to the City of St. Louis to place, construct and maintain in said Private Places, Sewers, Sewer Inlets, Water Mains, gas Mains, underground conduits for Electric Wires, Fire plugs, Lamp posts, and other conveniences for the Public Service and use of the City. IN WITNESS Whereof the BEREDITH REALTY COMPANY has caused these presents to be signed by its President, its Corporate Seal to be affixed, attested by its Secretary this the 10th day of November 1905.

Attest BEREDITH REALTY COMPANY
J.H Aug Meyer, Asst Secy
by A.A.B. Woerheide its President
BEREDITH REALTY COMPANY
Incorporated June 23, 1904

STATE OF MISSOURI \

CITY OF ST LOUIS / On this 10th day of November 1905 before me appeared A.A.B. Woerheide to me personally Known

Who being by me duly Sworn did Say that he is the President of BEREDITH REALTY COMPANY and that the Seal affixed to the foregoing instrument is the Corporate Seal of said corporation, and that said instrument was Signed and Sealed in behalf of Said Corporation by authority of its Board of Directors and said A.A.B. Woerheide acknowledged said instrument to be the free act and deed of said corporation.

IN TESTIMONY Whereof I have hereunto set my hand and affixed my Official Seal at my Office in the City of St. Louis MO this the day and Year last above written. My Term expires Sept 2, 1908, Ormand McCawley Notary Public, City of St. Louis MO

THE UNDERSIGNED hereby Certifies itself to be the owner and legal holder of Notes secured by the deed of Trust made by BEREDITH REALTY COMPANY to LINCOLN TRUST COMPANY Trustee for PARKVIEW REALTY and Improvement Company, dated July 9, 1904 and recorded in BOOK 1792 Page 11 in the Office of the Recorder of Deeds of ST LOUIS and in consideration of the sum of ONE Dollar, the receipt of which is hereby acknowledged, hereby releases unto the City of St. Louis the ground embraced in the Strips of Land dedicated on the foregoing PLAT of "PARKVIEW" or upon which easements are granted.

IN WITNESS Whereof the LINCOLN TRUST COMPANY has caused these presents to be signed by its proper officers.

this the 10th day of November 1905

LINCOLN TRUST COMPANY, owner & legal holder of Notes

Attest Chas Hamilton, Secty

by A.A.B. Woerheide its President

STATE OF MISSOURI \

CITY OF ST LOUIS / On this 10th day of November 1905 before me appeared A.A.B. Woerheide to me personally Known, who being by me duly Sworn, did Say that he is the President of LINCOLN TRUST CO, and that the Seal affixed to the foregoing instrument is the Corporate Seal of Said Corporation, and that said instrument was Signed and Sealed in behalf of Said Corporation by authority of its Board of Directors, and said A.A.B. Woerheide acknowledged said instrument to be the free act and deed of said corporation.

IN TESTIMONY Whereof I have hereunto set my hand and affixed my Official Seal at my Office in the City of St. Louis, this the day and Year last above written.

My Term expires Sept 2, 1908,

Ormand McCawley, Notary Public, City of St. Louis